

PREVENTATIVE MAINTENANCE SCHEDULE- XCITE™ AIRMIX®

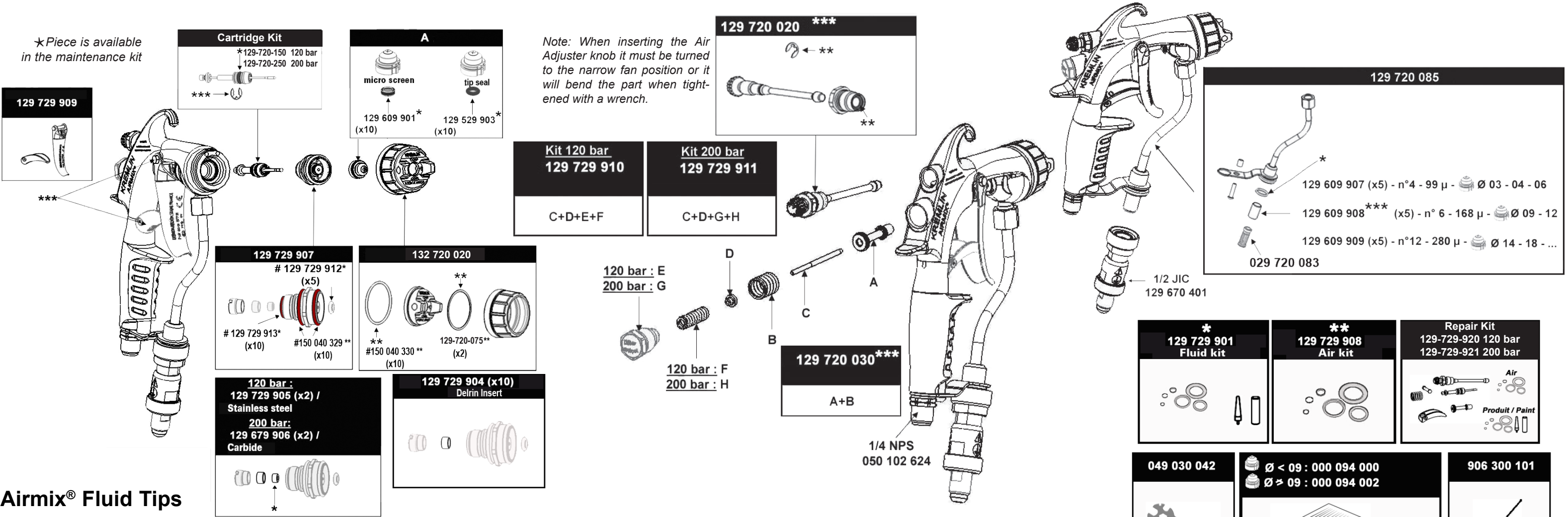

Airmix® Fluid Tips

Tip Number	Fluid Output				Diameter in Inches	Diameter in mm	Gun Filter		Pump Filter		Spray Angle and Max fan width at gun target distance of 10" from Substrate													
	500 psi 35 bar		1000 psi 70 bar								10°	18°	30°	40°	45°	50°	60°	67°	75°	82°	90°			
	oz/ min	cm³/ min	oz/ min	cm³/ min							3.5"	5"	7"	9"	9.5"	10"	12"	13"	15"	18"	22"			
	oz/ min	cm³/ min	oz/ min	cm³/ min			Mesh	Filter #	Mesh	Filter #	9 cm	13 cm	18 cm	23 cm	24 cm	25 cm	31 cm	33 cm	38 cm	46 cm	60 cm			
02	1.2	40	3.4	100	0.005	0.127	140 (4)		200 (2)	02-03	02-05													
03	3.4	100	5.1	150	0.007	0.178				03-03	03-05	03-07												
04	5.1	150	6.8	200	0.009	0.229			140 (4)	04-03	04-05	04-07	04-09	04-10	04-11	04-13								
06	6.8	200	11.2	330	0.011	0.279				06-03	06-05	06-07	06-09	06-10	06-11	06-13	06-15							
09	10.1	300	15.2	450	0.013	0.330	85 (6)		85 (6)	09-03	09-05	09-07	09-09	09-10	09-11	09-13	09-15							
12	11.2	350	20.3	600	0.015	0.381			70 (8)		12-05	12-07	12-09	12-10	12-11	12-13	12-15	12-17						
14	13.5	400	24.4	720	0.016	0.406	60 (12)			60 (12)	14-03	14-05	14-07	14-09	14-10	14-11	14-13	14-15	14-17					
18	15.2	450	28.7	850	0.018	0.457					18-05	18-07	18-09	18-10	18-11	18-13	18-15	18-17						
20	16.9	500	35.8	1,060	0.020	0.508						20-07	20-09	20-10	20-11	20-13	20-15	20-17	20-19					
25	22.0	650	45.0	1,330	0.022	0.559						25-07	25-09	25-10	25-11	25-13	25-15	25-17						
30	25.4	750	54.1	1,600	0.024	0.610						30-07	30-09	30-10	30-11	30-13	30-15	30-17	30-19					
40	33.3	985	66.6	1,970	0.027	0.686							40-09	40-10	40-11	40-13	40-15	40-17	40-19	40-21				
45	38.9	1150	77.8	2,300	0.029	0.737								45-10	45-11	45-13	45-15	45-17	45-19	45-21				
60	43.3	1281	86.6	2,561	0.031	0.787								60-10	60-11	60-13	60-15	60-17	60-19	60-21				

**Standard tips**  
To order a tip, replace the crosses in 134-5xx-xx4 with the corresponding number from the chart above. (Example: 134-506-094 for a 06-09 tip) When ordering a 100 tip, use 134-xxx-xx4 (Example: 134-100-134).

**Xtra™ tips**  
To order a tip, replace the crosses in 134-5xx-xx2 with the corresponding number from the chart above. (Example: 134-506-092 for a 06-09 tip) Ideally used for waterborne materials.

**Special Order tips** - These tips require a minimum of 25 tips per order and these tips cannot be ordered in the Xtra™ tip style.

**Optimum Fan Adjustment**  
- These tips allow for fan adjustment when used with a VX24 air cap.



http://www.kremlinrexson-sames.com/en/usa/

**EXEL North America, Inc.**  
North American Headquarters  
45001 5 Mile Road  
Plymouth, MI 48170  
Toll Free: (800) 573-5554  
Phone: (734) 979-0100  
Fax: (734) 927-0064

**EXEL North America, Inc.**  
Canadian Branch  
931 Progress Ave., Unit 7  
Scarborough, Ontario M1G 3V5  
Toll Free: (800) 450-0655  
Phone: (416) 431-5017  
Fax: (416) 431-9171

**EXEL-NA, S.A. de C.V.**  
Acceso III N°16A Int 15A  
Conjunto Quadrum  
Parque Industrial Benito Juárez  
Santiago de Querétaro, Qro.  
México, C.P. 76120



# PREVENTATIVE MAINTENANCE SCHEDULE- XCITE™ AIRMIX®

## DO THIS BEFORE ANY MAINTENANCE ACTION:

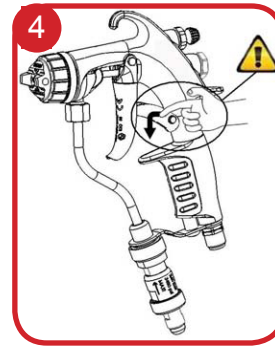
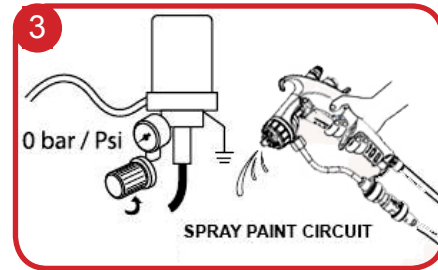
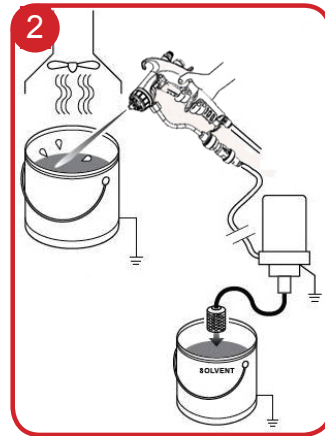
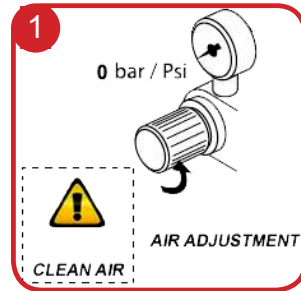

## DAILY MAINTENANCE:

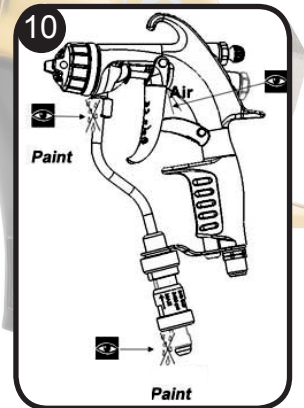
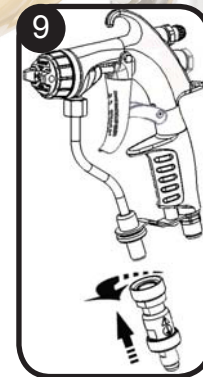
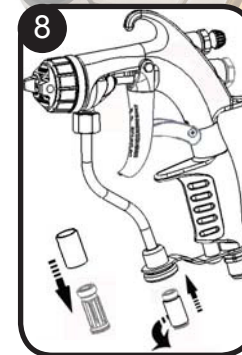
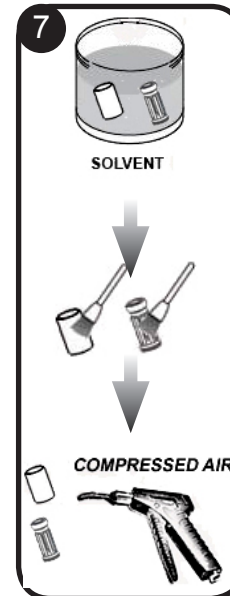
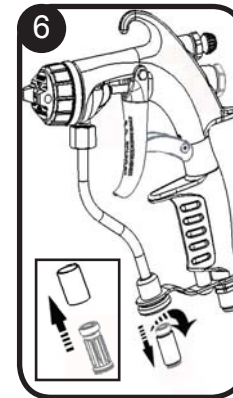
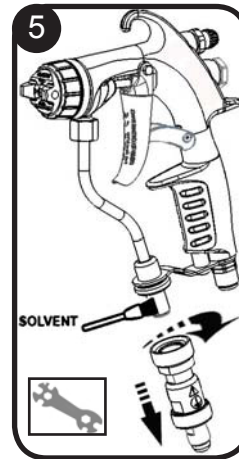
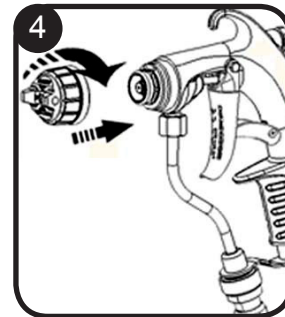
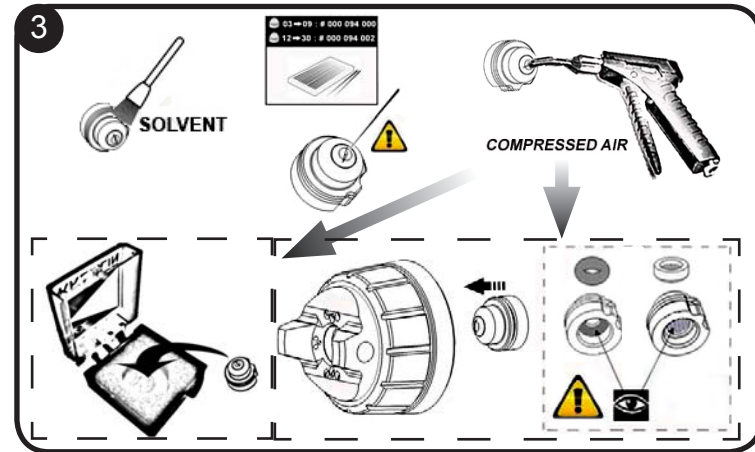
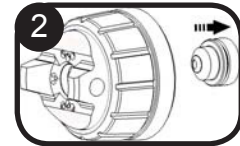
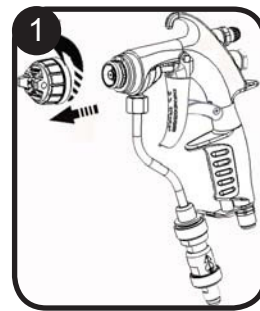

## WEEKLY MAINTENANCE:

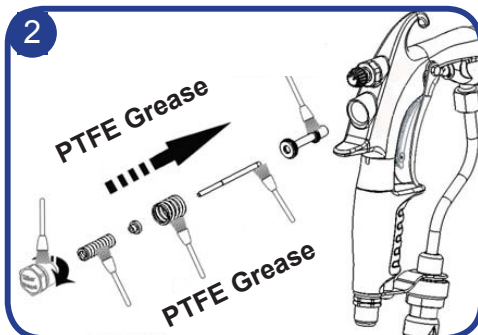
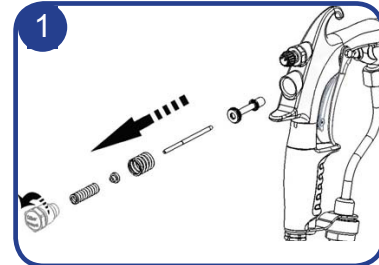
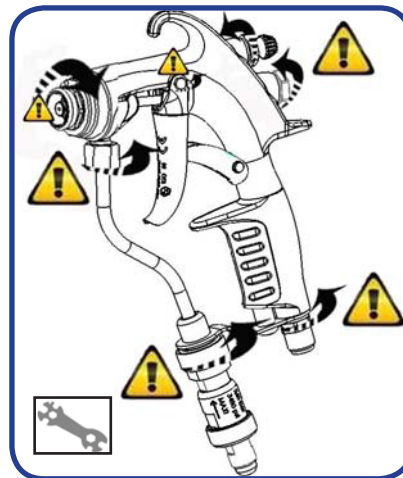

## QUARTERLY MAINTENANCE:

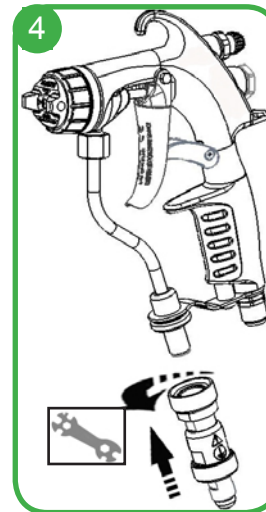
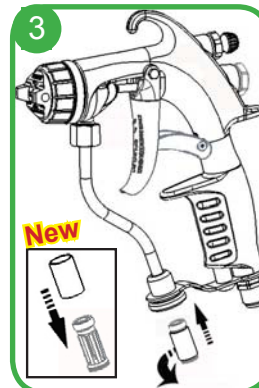
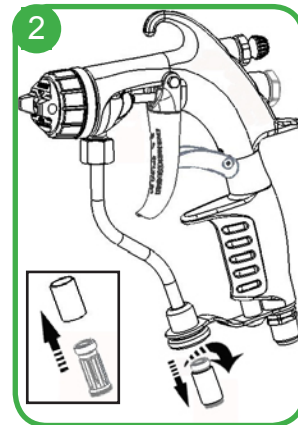
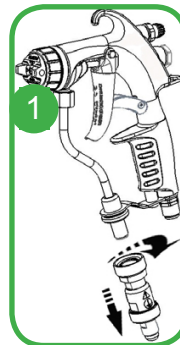

## YEARLY MAINTENANCE:

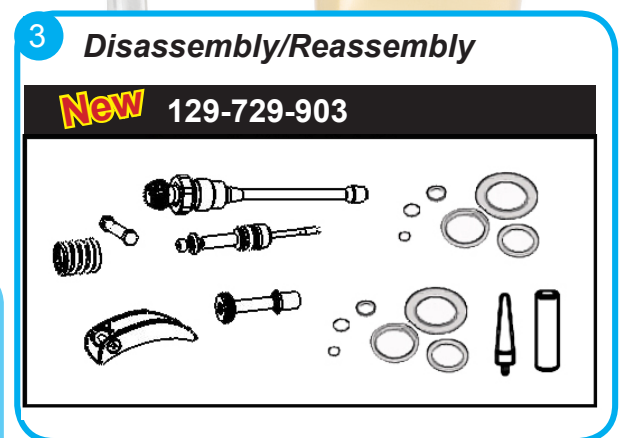
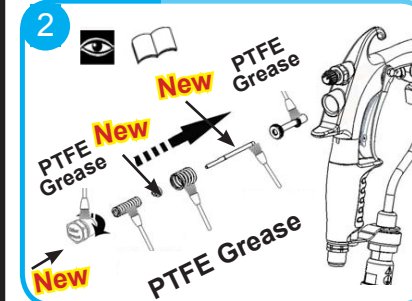
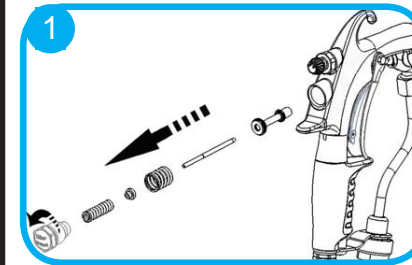

Clean the air passages on the nozzle and inspect the nozzle O-ring weekly.

Replace tip seals monthly.  
Tips should be "donut" shaped not flat.